

TOYOTA TACOMA '05 TO '15 SUPPLEMENTAL INSTALL SHEET

⚠ IMPORTANT: READ FIRST ⚠

- 1** Before installing the D-shaped bulkhead seal to the top of the truck bulkhead, trim the end to match the truck's bed cap.

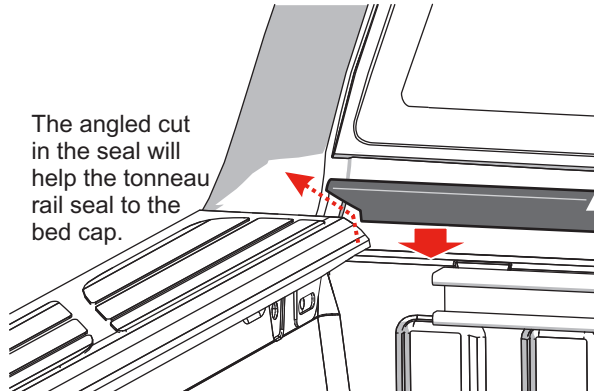

As you adhere the bulkhead seal, match the other end to the bed cap and trim it also to fit the cap's edge.

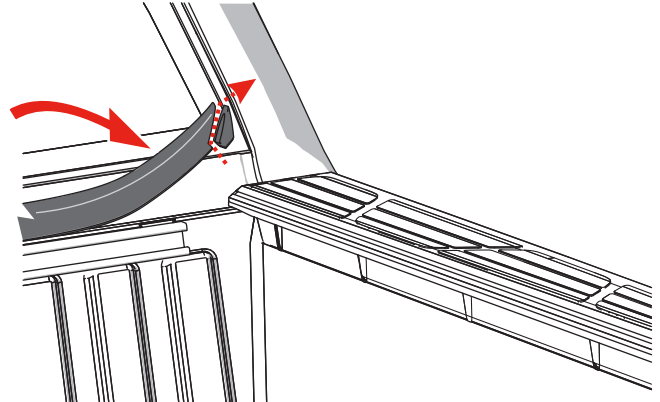

- 2** Remove factory installed accessory track system Torx screws and side channels.

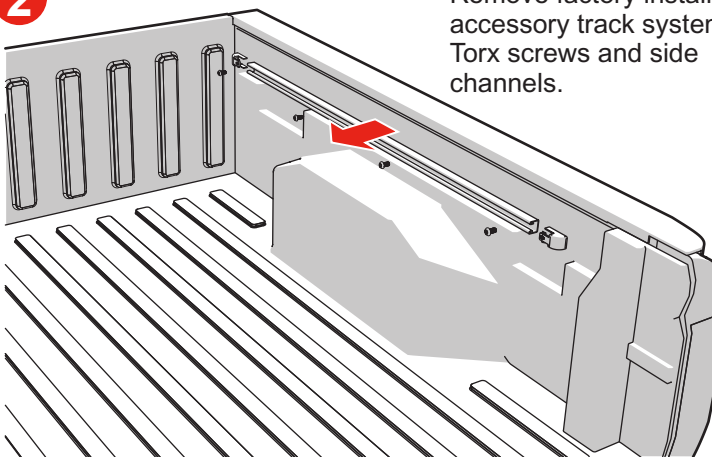

- 3** Place the tonneau rail onto the truck bed rail. Make sure the rail mounting bracket is tight up against the front of the bed.

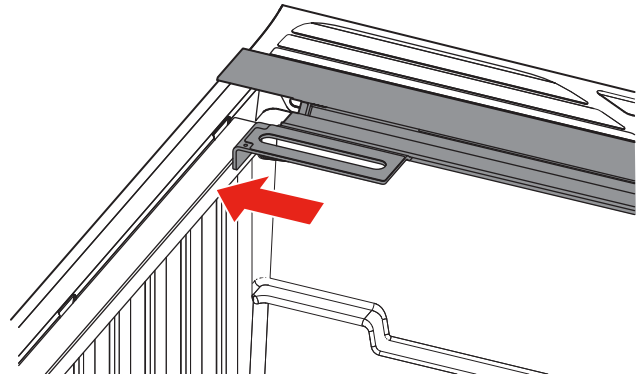

- 4** Mount the rail by inserting the bolt through the slotted hole of the bracket, through the hole in the rail, and into the truck bed where the factory channel was installed.

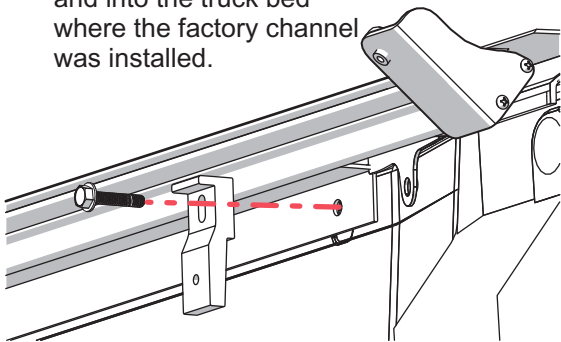

- 5** Slide a Z-brace behind the rail and latch lever between the rail and truck cap. Both sides.

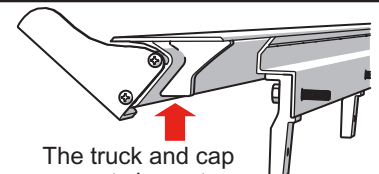
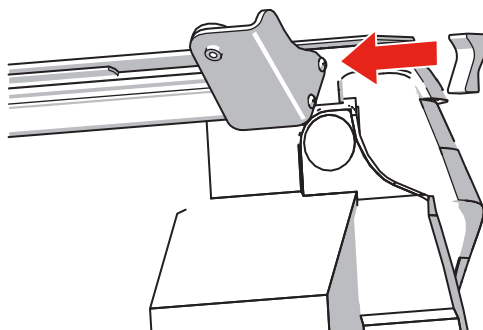

The truck and cap are not shown to demonstrate the location of the Z-braces.

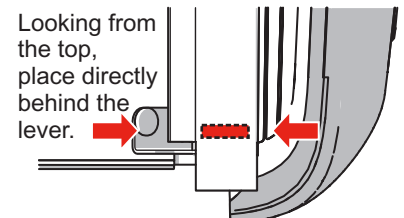

- 6** Loosely tighten the bolts making sure the bracket is pushed up firmly into the tonneau rail.

Leaving the bolts slightly loose will help with alignment in step 8.

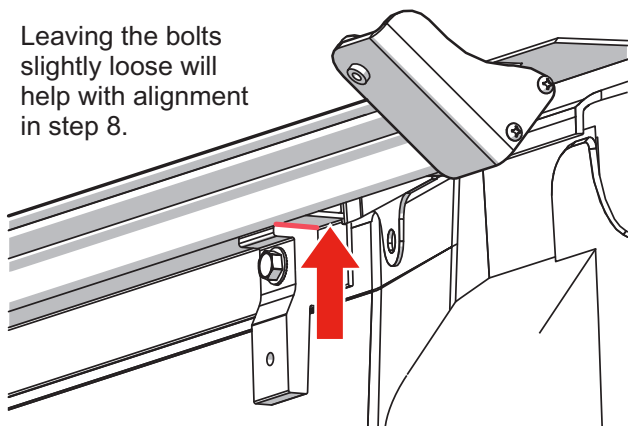

When tightening the bolts, make sure the Z-braces remain in place.

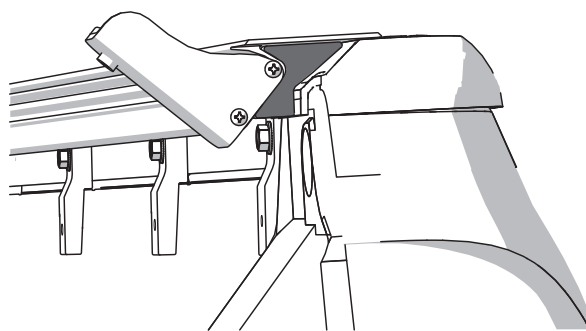

7

Slide the retainer straps into the factory channel.

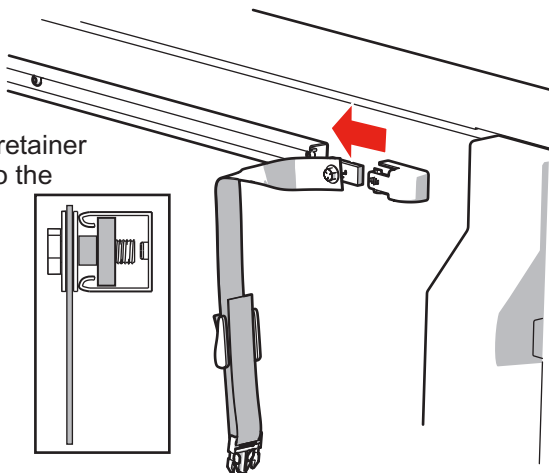

8

Using the supplied hardware, align the factory channel with the lower holes of the bracket and mount the channels.

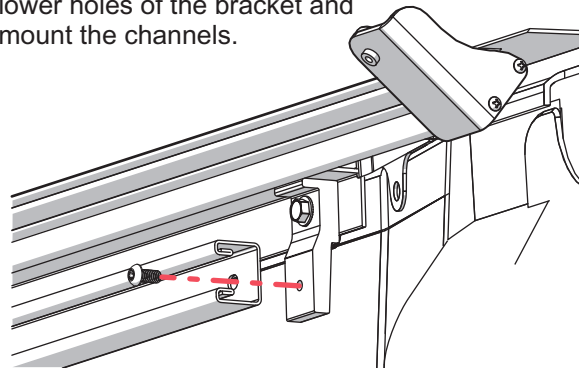

9

Tighten all of the mounting hardware and replace the factory channel end caps.

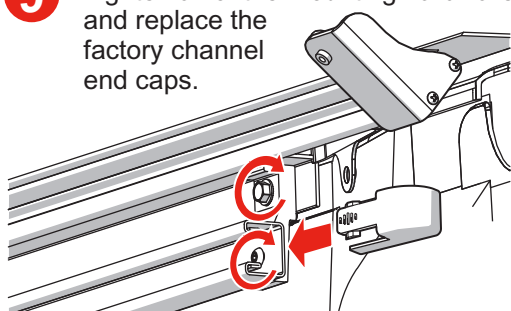

When tightening the bolts for the brackets, make sure the tonneau rail is tight up to the front of the bed.

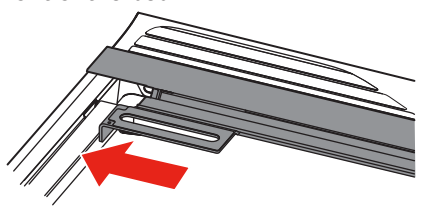

10

Using the remaining section of the bulkhead seal, trim two small tapered pieces, one for each side, and adhere them to the underside of the tonneau rail at the tailgate.

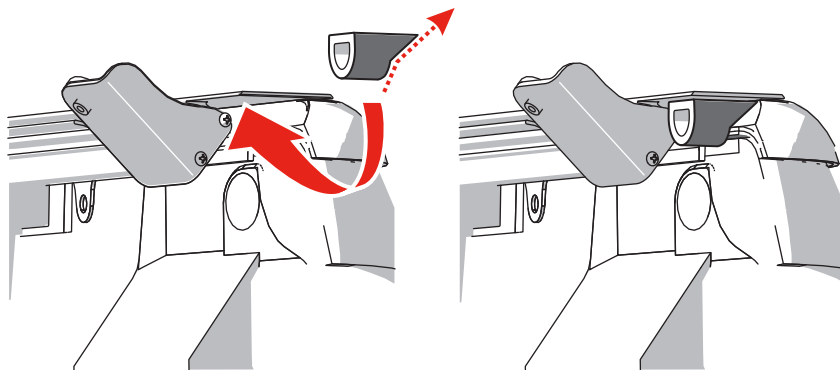

These small additions will help to further seal your new tonneau to the truck bed and bed caps.

Return to standard Installation Sheet and skip to Step 8.